



The
WOOD[®]
Wall Panel Co



*SPECIALISING IN
WALL PANELS
FOR INTERIOR
AND EXTERIOR
APPLICATION*



The
WOOD[®]
Wall Panel Co

Acoustic Slat Wall Panels



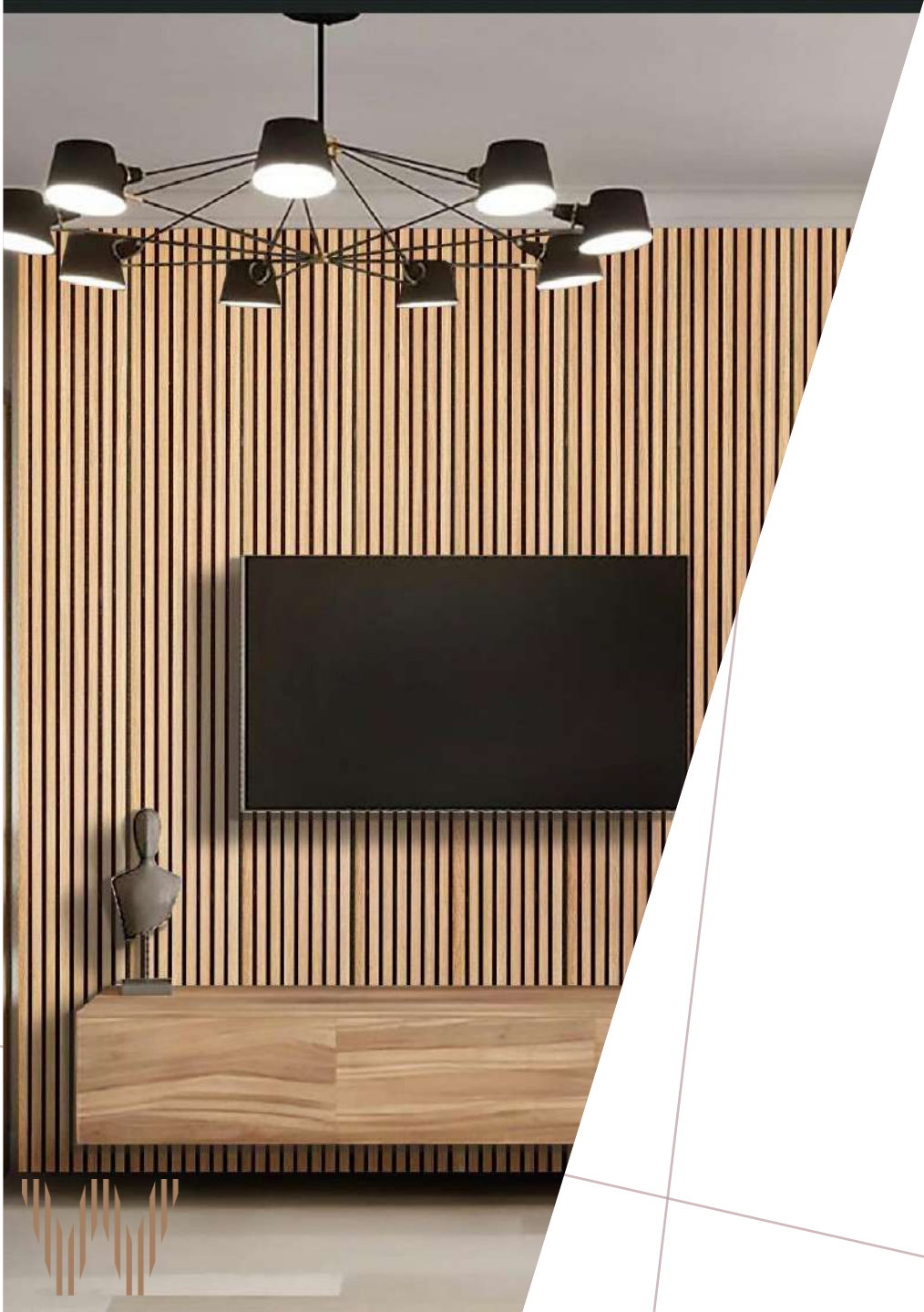

PRODUCT INFORMATION

Acoustic slat wall panels are a very 'in-trend' product as a decorative feature with the added benefit of great acoustic properties.

Manufactured using one of the densest grade PET Felt backing on the market manufactured using 100% recycled materials (plastic bottles), 10mm dense black core MDF slats securely fixed using heavy duty staples and topped with a natural wood veneer finish adhered using a unique heat transfer adhesive.

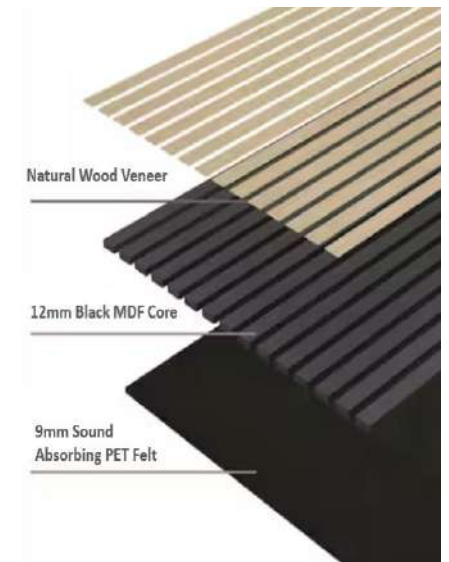

SPECIFICATION



Product	Wood Slat Acoustic Wall Panel
Base Material	100% Recycled PET Felt 1700 m/g2 density
Surface Material	9mm Dense Black MDF wooden slat with Veneer finish
Dimensions	2400mm (L) x 600mm (W) x 21mm (D)
Slat Detail	Slat width 27mm Distance between slats 13mm Number of slats per panel 15
Coverage	1.44m² per panel
Weight	Approximately 12kg per panel
Available Colours	Natural Oak Walnut Light Grey Oak Burnt Walnut Black Oak
Features	Easy to Install Acoustic Light Weight Decorative Sustainable
Usage	Interior Design Accent & Feature Wall Focal Point Ceiling Acoustics
Application	Domestic Property Office Retail Education Healthcare Sound Studios Cinemas Commercial Property Gyms

ACOUSTIC DATA

Frequency/Hz	Reference Curve	Practical Sound Absorption Coefficient, α_p	Weighted Sound Absorption Coefficient, α_w	Sound Absorption Class
125	-	0.35	0.90	Class A
250	0.70	0.70		
500	0.90	0.95		
1000	0.90	0.80		
2000	0.90	1.00		
4000	0.80	1.00		

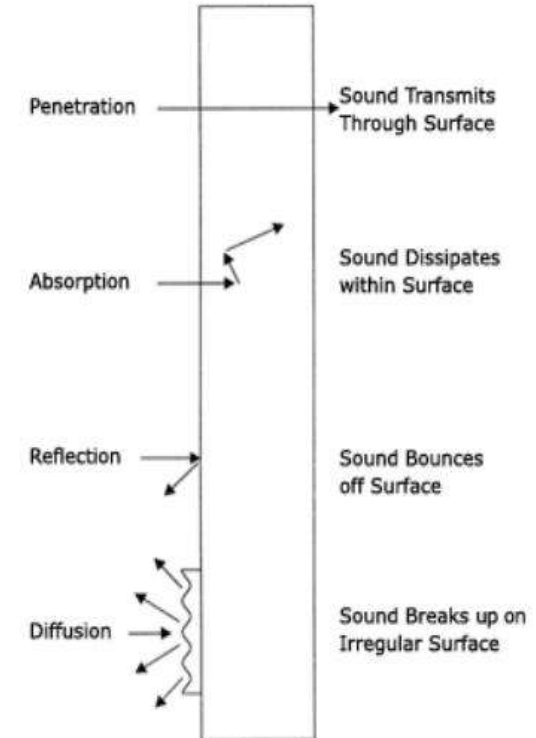
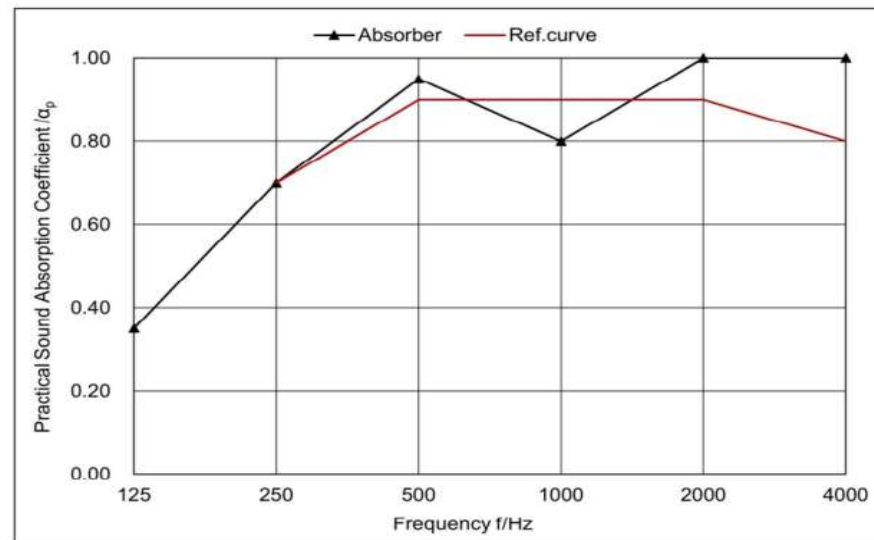

INSTALLATION - ADHESIVE



Before you start installation

- Measure the area the panels are to be installed and decide on the layout and design.
- Ensure enough panels are purchased to cover – due to the natural wood veneer of the panels, colour variations amongst batches may be noticeable.
- Remove any screws, nails or other fixings, fill any holes and sand down to give a smooth surface.
- Ensure the installation surface is clean of any dirt or debris using a damp cloth. Allow the area to dry thoroughly.

1. Measure the height of the installation wall. If panels need to be cut, mark the panels using a pencil and square edge (remember measure twice, cut once!) Cut the panels to size using a small-toothed handsaw. If the panels also need to be cut down in width, a sharp utility blade can be used to cut through the felt backing.
2. Using a heavy duty grab adhesive and caulk gun, apply adhesive to the back of the panel keeping adhesive a minimum of 50mm from the edges of the panel ensuring the whole panel has an even coverage to ensure good adherence to the surface.
3. Place the panel against the install surface ensuring it is level and in the correct position. Apply pressure to the front of the panel to give a good fix to the wall. Make sure the panel isn't disturbed until sufficient drying time has elapsed to fix in place.
4. Install the second and subsequent panels using the easy install card slot system to maintain a uniform finish. Continue until all panels are in place.

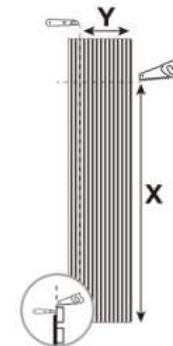
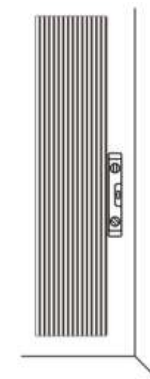
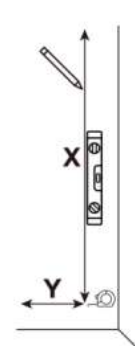
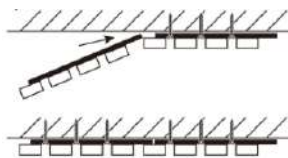

Important Notes:

- Use a small-toothed saw for cutting slats of panels
- Use a sharp utility knife for cutting felt backing of panels
- Use black 35mm screws
- If using battens, these should be 45mm fitted at 45cm centres
- 45mm Insulation roll can be used between battens for better acoustic performance
- For ceilings screw directly into joists
- If adding fixtures & fittings (e.g. shelves/TV brackets) drill through the panel and sub-wall and use appropriate fixings
- Intricate cuts for sockets, light switches etc. should be made using an electric jigsaw



INSTALLATION – SCREW FIX

1. Measure the height of the installation wall. If panels need to be cut, mark the panels using a pencil and square edge (remember measure twice, cut once!) Cut the panels to size using a small-toothed handsaw. If the panels also need to be cut down in width, a sharp utility blade can be used to cut through the felt backing.
2. Mark fixing points on the install surface in 5 rows of three approximately 575mm apart and ensure the outer fixing points are a minimum of 50mm in from the panel edge. Drill and insert appropriate fixings. Using black 35mm screws, fix the panel to the surface.
3. Install the second and subsequent panels using the easy install card slot system to maintain a uniform finish. Continue until all panels are in place.
4. Install the second and subsequent panels using the easy install card slot system to maintain a uniform finish. Continue until all panels are in place.

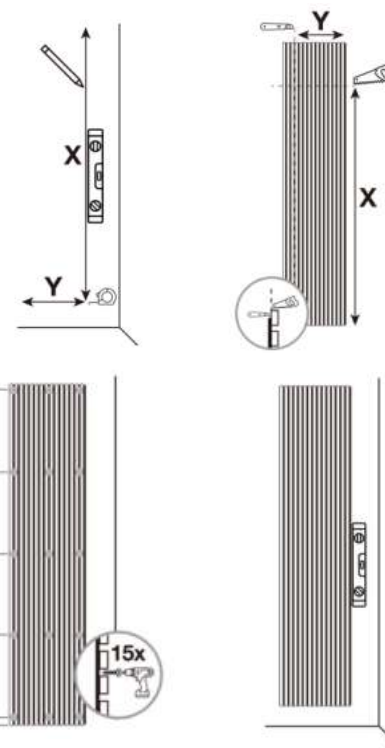

Before you start installation

- Measure the area the panels are to be installed and decide on the layout and design.
- Ensure enough panels are purchased to cover – due to the natural wood veneer of the panels, colour variations amongst batches may be noticeable.
- Remove any screws, nails or other fixings, fill any holes and sand down to give a smooth surface.
- Ensure the installation surface is clean of any dirt or debris using a damp cloth. Allow the area to dry thoroughly.

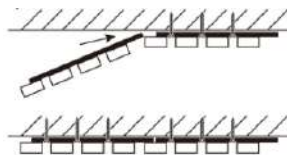

To achieve up to Class A

To improve the acoustic performance, install panels onto fixed battens.

The Wood Wall Panel Co recommend 45mm deep battens fixed at 575mm centres. The panels can be screw-fixed directly using black 35mm screws.

To further enhance the acoustic performance, a 45/50mm mineral wool insulation can be inserted into the cavity.



INSTALLATION FOR BEST ACOUSTIC PERFORMANCE

To achieve Class A Acoustic Performance

1. Install timber battens at 575mm centres.
2. Battens should be a minimum of 45mm x 45mm.
3. Insert 45-50mm cavity wall insulation between battens.
4. Measure the height of the installation wall. If panels need to be cut, mark the panels using a pencil and square edge (remember measure twice, cut once!) Cut the panels to size using a small-toothed handsaw. If the panels also need to be cut down in width, a sharp utility blade can be used to cut through the felt backing.
5. Using black 35mm screws, fix the panel to the batten through the PET felt.
6. Install the second and subsequent panels using the easy install card slot system to maintain a uniform finish. Continue until all panels are in place.

Before you start installation

- Measure the area the panels are to be installed and decide on the layout and design.
- Ensure enough panels are purchased to cover – due to the natural wood veneer of the panels, colour variations amongst batches may be noticeable.
- Remove any screws, nails or other fixings, fill any holes and sand down to give a smooth surface.
- Ensure the installation surface is clean of any dirt or debris using a damp cloth. Allow the area to dry thoroughly.

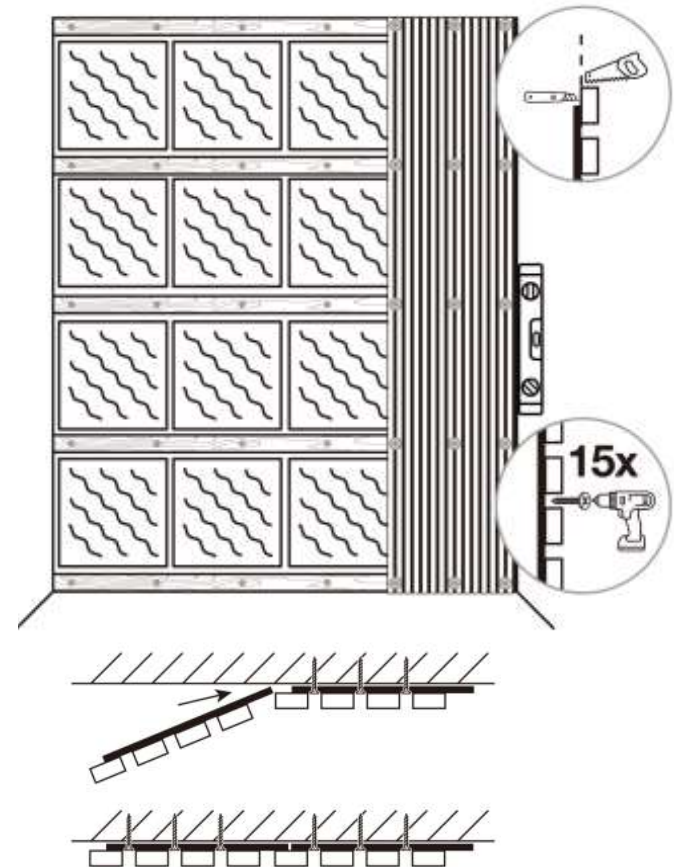

ACCESSORIES



Natural Oak



Walnut



Light Grey Oak



Burnt Walnut

Single Slat finishing edge trims are the perfect addition to conceal the visible edge of an install. Available in four colours and manufactured using the same high-quality materials, the edge trims are 2.4m long x 27mm wide x 21mm deep and are fixed using adhesive applied to the lipped edge.

UNIQUE SELLING POINTS

- **Ease of installation with card slot detail**
- **Choice of installation methods to suit requirements**
- **Versatile**
 - **Can be used in varying scenarios to cover all tastes - from a full wall install to a 'design' feature**
 - **Can be install vertically or horizontally depending on design requirement**
 - **Can be installed on both walls and ceilings**
- **Easy to cut using standard tools**
- **High grade 100% Recycled PET felt backing giving up to Class A Acoustic performance**
- **Decorative – will enhance any surface and space**
- **Labour and cost saving – quicker and longer lasting than traditional decorating**
- **Sustainably sourced real wood veneer finish**
- **Sustainable & Durable**
- **Can be painted, oiled, stained, varnished to suit any taste and finish required**
- **Easy to clean and maintain**



FREQUENTLY ASKED QUESTIONS

Can I install the panels outside?

The acoustic wall panels are manufactured for internal, decorative use and are not weather proofed for external use.

Can you only install the panels vertically?

No, the panels can be installed vertically or horizontally depending on the design and finish required. They can also be installed on the ceiling (we would recommend screw-fixing into existing joists or to timber battens for this).

Can I hide the edges of the panels?

The panels have been designed and engineered to show an exposed edge as a design feature. Corner/edge trims are available in the same finish as the panels if this is something required for an alternative finish.

Is it easy to install the panels around existing sockets or features?

Installing around sockets or existing features is not a problem. Firstly, hold the panel to the wall where the socket/feature is and mark where it is on the panel. The panels can be cut easily with a fine-toothed electric jigsaw. Use a damp cloth to remove any sawdust/debris from the cut area before installing.

Can I use the panels in a shower or bathroom?

The panels are manufactured using MDF slats and real wood veneers and as such are not moisture or waterproof. We do not recommend using them in areas of high moisture as this will lead to damage over time.

How do I keep my panels clean and looking good?

To clean just use an anti-static duster to remove light dust and debris. If a little more is needed, a damp cloth can be used.

INSPIRATION...





SplashPro 100% Waterproof and Water-resistant Slat Wall Panels



SLASH PRO WATERPROOF RANGE OF SLAT WALL PANELS

Designed and manufactured to give the same decorative benefits of our acoustic panels, our SplashPro Waterproof panels are manufactured using recycled polystyrene and high-quality resins to give a dense, hard-wearing, light-weight panel that is easy to install and gives a timeless and practical finish to any area.

Ideal for use in bathrooms, shower rooms, kitchens and high traffic areas to name just a few, the SplashPro range of panels are an effective addition for countless install requirements and have the added benefit of being 100% waterproof (dependant on installation process), easy to clean and maintain, fade and rot-resistant, labour-saving and hard-wearing.





SPLASH PRO WIDE SLAT PANELS

SplashPro Premium range Wide Slat Panels come in a range of colours to suit every taste and installation requirement.

Hard wearing, waterproof, decorative, easy to install, lightweight, eye-catching and easy to clean and maintain, the panels give the appearance of a natural timber slat wall without the labour-intensive requirements.

A perfect addition to give areas of high humidity and high use that boost. Create a talking point and design feature that will last for years.

SPECIFICATION

Product	Water Resistant/Water Proof 3D PS Wall Panel
Base Material	90% Recycled Polystyrene and 10% Virgin Materials
Dimensions	2400mm x 315mm x 7mm
Slat Detail	Slat Width 71.5mm Distance between slats 7mm
Coverage	0.756m2 per panel
Weight	2.36kg per panel
Finishes	Natural Oak Smoked Oak Washed Oak
Features	Waterproof Light Weight Easy Install Interlocking Design Eco-friendly Durable Decorative Low Maintenance
Application	Bathrooms Kitchens Shower Rooms Restaurants Hospitals Schools Hotels Commercial Buildings Retail

ACCESSORIES



Waterproof Right-Hand Edge Trim

Right hand finishing trim colour and finish-matched to SplashPro panels. Can also be used as a single slat to finish install.

Dimensions: 2.6m x 72.6mm x 7mm



Waterproof Left-Hand Edge Trim

Left hand finishing trim colour and finish-matched to SplashPro panels to give a clean finished edge. Can also be used as a single slat to finish install.

Dimensions: 2.6m x 83.6mm x 7mm



SPLASHPRO NARROW SLAT PANELS

Designed and manufactured to replicate the look and design of our acoustic panels, our narrow slat panels have the same great timeless look of timber with the added benefit of being 100% waterproof.

Available in the extremely popular natural oak and walnut finish with the same characteristic slat detail, the panels are also easy to install, lightweight, hardwearing and low maintenance.



SPECIFICATION

Product	Waterproof PS Wall Panel
Base Material	High Impact Recycled Polystyrene & Resin Colour Finish
Dimensions	2400mm x 200mm x 11mm
Slat Detail	Slat Width 37mm Distance between slats 8mm
Coverage	0.48m2 per panel
Weight	1.56kg per panel 9.6kg per carton
Quantity	6 x panels 2.88m2 per carton
Finishes	Natural Oak Washed Oak Smoked Oak
Features	Waterproof Light Weight Easy Install Interlocking Design Eco-friendly Durable Decorative Low Maintenance
Application	Bathrooms Kitchens Shower Rooms Restaurants Hospitals Schools Hotels Commercial Buildings Retail

INSTALLATION INSTRUCTIONS

Before you start installation ...

1. Decide on the preferred orientation of the panels. The panels can be installed horizontally, vertically or diagonally dependant on the finished design preference required.
2. Prepare the installation area by ensuring that the base surface is free of all nails, screws and any other pre-existing fixing, any holes are filled and sanded to a smooth finish and the surface is clean and clear of any dirt and debris. If the panels are being installed in a 'wet' area such as a shower or wet room or areas of high humidity, it is recommended although not essential that the installation surface is protected from moisture using a tanking kit or another form of water proofing membrane designed for wet areas.
3. Panels should be climatized before installation for at least 24 hours in the room or area in which installation is to be made. This should be done with the packaging removed.

Installation:

1. Measure the height of the installation wall. If panels need to be cut, mark the panels using a pencil and square edge (remember measure twice, cut once!) Cut the panels face up to the required size using a sharp small-toothed handsaw. **Top tip – placing tape along the line of the cut reduces mess and risk of marking. Edges can be smoothed with a fine sandpaper if required*
2. Using a solvent free waterproof grab adhesive and skeleton gun, apply adhesive to the back of the panel to each of the raised ridges.
3. Place the panel against the install surface ensuring it is level and in the correct position and the tongue is to the right. Apply pressure to the front of the panel to give a good fix to the wall. Remove any excess sealant with a soft, damp cloth before fixing subsequent panels.
4. For the next and subsequent panels, apply adhesive to the ridged areas and also to the 'lip' of the panel which will interlock with the panel already in place to help create a waterproof seal between panels.
5. Apply a clear silicone sealant to the joints wiping away any excess to ensure the area is waterproof.
6. Co-ordinating mouldings are available to finish off the top edge and external corners of the install if required. This is fixed using the same adhesive and clear silicone sealant.

Tools required:

- Tape Measure
- Pencil
- Spirit Level
- Fine-toothed saw
- Electric jig-saw (for cut-outs)
- Spirit Level
- Skeleton Gun
- Strong waterproof solvent-free grab adhesive
- Clear Silicone Sealant

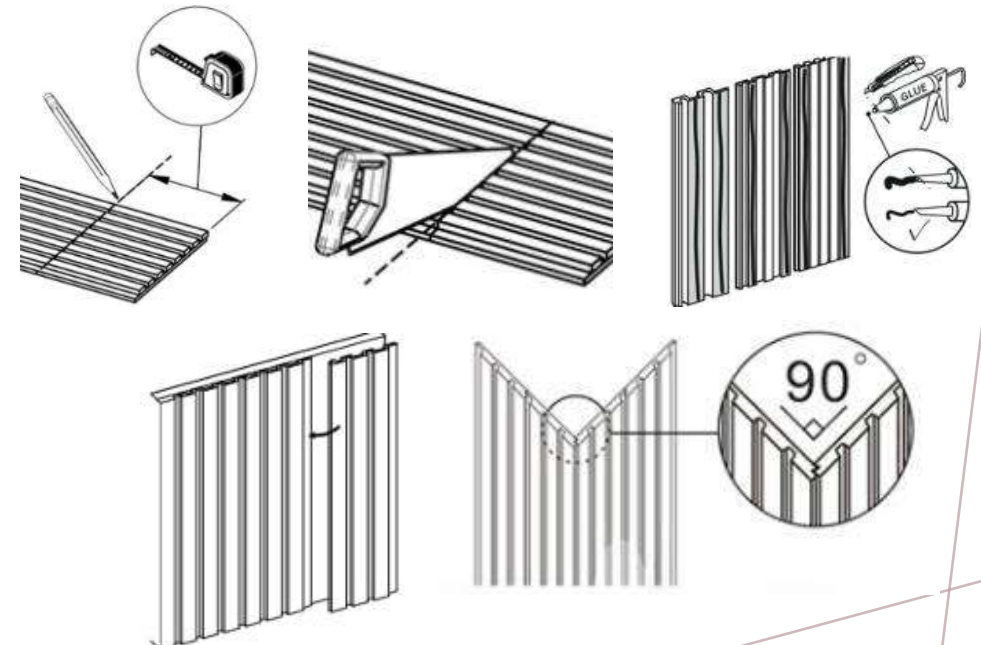
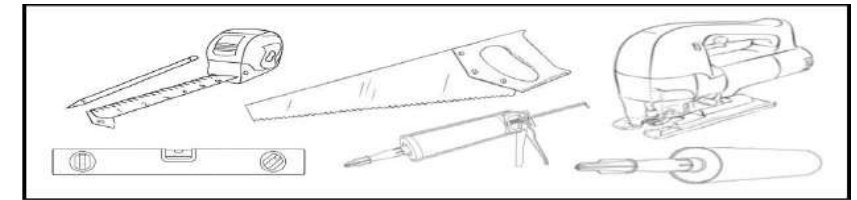

UNIQUE SELLING POINTS

- Ease of Installation with unique design
- 100% Waterproof/Water resistant
- Versatile and can be used in a multitude of scenarios
- Can be installed directly onto multiple surfaces, including ceramic tiles
- Lightweight and easy to move
- Labour and cost saving
- Sustainable and durable
- Mould and rot resistant
- Decorative and timeless

FREQUENTLY ASKED QUESTIONS

How do the panels arrive?

The panels are individually wrapped and come in boxes of 6 panels giving an m2 coverage of 4.914m2.

Can I install the panels on any surface?

The panels can be installed on any surface, including brick, concrete, timber, plasterboard and over ceramic tiles plus more. The surface must be clear of any debris, obstructions and grime. We recommend that the surface is treated with a waterproof coating ("tanked") prior to installation for waterproofing.

What do I do if I have fixtures and fittings to install around?

It is quite straightforward to cut the panels to fit around any object with the use of a fine-bladed jigsaw. Once installed, ensure that any edges of panelling are sealed with a clear, waterproof silicone sealant to stop moisture getting through.

Can the panels be used in a bathroom or kitchen?

Absolutely! The panels are designed and manufactured to be 100% waterproof so are ideal for any areas of high moisture and humidity. They are not recommended for use in areas of high temperatures so behind a hob/cooker is not recommended.

How do I install the panels?

The panels are super easy to install. The tongue and groove design means that the spacing is always perfect giving a seamless finish. The panels can be installed using a waterproof, solvent-free adhesive.

Can the panels be used outside?

SplashPro panels are not recommended for use in external areas.

Do the colours shown look like the panels in real life?

Although we do our best to show the panels as real to life as possible, we cannot guarantee that the image you see is the same as the real thing. Monitor settings and lighting can affect the images. All our panels are manufactured using the highest quality resin finish for colour-fastness and look. We have a sample service available to 'try before you buy'.

How can I hide the edges of the panel?

We have matching edge and corner mouldings available for all SplashPro panels, or for a different look the use of a suitable L-shape trim available from the majority of major DIY chains can be used to finish off any visible edges. This should be finished with a clear silicone sealant to reduce the risk of water ingress.

INSPIRATION IMAGES





WOOD WALL PANEL MULTI- PURPOSE ADHESIVE

GRIPS AND STICKS LIKE NO OTHER

Description

A clear silicone sealant suitable for use with both the acoustic and waterproof panels. Easy to use with fast cure time for high strength bonding to any surface.

Surface Preparation

Install surface must be clean, dry and free from any dust, grease and other contaminants.

For areas such as bathrooms and showers where waterproof panels are being installed, tanking of the substrate may be needed prior to install to reduce the risk of water ingress.

For installing direct onto ceramic tiles, wash down with sugar-soap or similar to remove any buildup of chemicals etc. and ensure completely dry before installing panels.

Application temperature must be between +5°C and +40°C

Features

Suitable for all environments. Non-corrosive and odourless. Highly UV resistant. Waterproof. Fungi, mould and bacteria resistant.

Usage

Domestic, Commercial, Retail, Schools, Hospitals, Cinemas, Restaurants, Offices

Application

Step 1:

Ensure install surface is clean and clear of any debris, dust and grease and any existing nails etc. are removed.



Step 2:

Apply to the panel as per the relevant installation instructions.



Step 3:

Press surfaces firmly together.



- ✓ Waterproof
- ✓ UV Resistant
- ✓ Suitable for fixing to multiple surface:
- ✓ Doesn't shrink or crack
- ✓ Resistant to bacteria and mould
- ✓ Acetate free
- ✓ Fast curing time
- ✓ Adhesive & Sealant in one

Multi-Purpose Silicone Adhesive & Sealant for use with Acoustic & Waterproof Panels



Wood

Metal

Plastic



Glass

Aluminium

Plasterboard



Rigid PVC

Ceramic

Concrete



SHADOWCLAD EXTERIOR PANEL

Designed and manufactured to replicate the look and design of our acoustic panels, our ShadowClad exterior panels are manufactured from WPC material using a unique co-extrusion technique to give them the look of real timber with the added benefit of a 'capped' finish making them highly UV and fade resistant, durable, water and weather-proof, rot, splinter and mould resistant and low maintenance and additionally are super-easy to install and a very versatile product.

Whether you are looking to update the look of the exterior of your home, clad an outside office or garden room, or looking for a durable and aesthetic alternative to traditional fencing – ShadowClad is perfect for a vast number of scenarios and requirements.



SPECIFICATION

Product	ShadowClad WPC Exterior Slat Wall Panel
Base Material	Wood Composite
Dimensions	2900mm x 175mm x 25mm
Slat Detail	Slat Width 35mm Distance between slats 15mm
Coverage	0.435m ² per panel
Finishes	Golden Oak Silver Grey Oak Charred Deep Black Oak
Features	Easy Install Durable Scratch & Fade Resistant Low Maintenance
Application	Exterior Walls Domestic, Commercial Retail

INSTALLATION INSTRUCTIONS

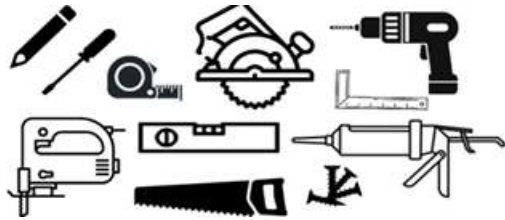

TOOLS REQUIRED

Pencil	Caulk Gun
Screwdriver	Carpentry Square
Tape Measure	Power Mitre Saw
Hand Drill	Circular Saw
Hand Saw	Fixings
Spirit Level	

1. Make sure surface is clear of any obstructions
2. Install battens running the opposite direction to the panels leaving a minimum 50mm gap from the base and 450mm between battens and a maximum of 500mm between fixings. Fix by pre-drilling the base surface and use wall-plugs and screws to suit (we recommend 5-6mm diameter & 80mm long screws). Battens must run the whole length of the installation area. When butt-jointing two panels (over 2900mm) double battens must be installed – each board must be secured to an independent joist.

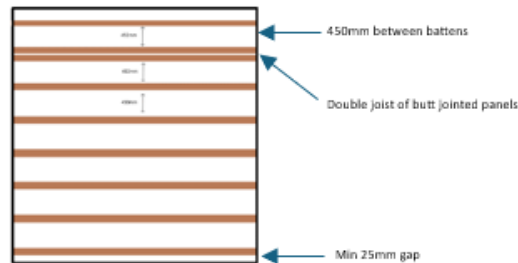

3. Measure and cut the panels to length – a gap of at least 25mm must be left between the bottom of the panel and the ground surface

4. Place the board in position. Mark and pre-drill pilot holes through the fixing groove of the panel into the battens below. Fix into place.
5. Slot the second board into place and repeat the fixing process ensuring that each panel is securely fixed to every batten.
6. Repeat this process until all the required panels are installed.
7. When finishing a corner, cut the last panel to the required width and fix into the battens using colour match screws through the low valley of the panel.
8. For corners, secure using a high strength solvent-free waterproof adhesive or alternatively by pre-drilling and fixing using colour match screws.
9. For external corners, the panels are designed to interlock to give a clean 90 degree finish.

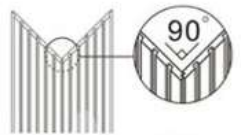
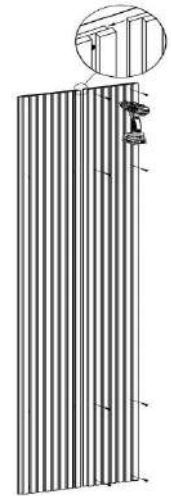

UNIQUE SELLING POINTS

- Made from recycled & sustainable materials
- Water and weather-proof
- Durable and hard wearing
- Versatile – can be used in a variety of scenarios from exterior walls and garden buildings to fencing and gates
- UV and Fade Resistant
- Rot, split and mould resistant
- Long lifespan and warranty
- Easy to install shiplap slot design
- Low maintenance – does not need treating or staining
- Labour and money saving

FREQUENTLY ASKED QUESTIONS

What are External Slat Wall Panels?

External Slat Wall Panels are a lightweight and durable and manufactured using a combination of hard wood fibres and recycled plastics. The use of this mix of materials means the panels can be used on both exterior and interior installations. It is weather and waterproof and gives an aesthetically pleasing and low maintenance finish to any area. Composite products are widely used as a better alternative to traditional timber alternatives. They provide protection from the elements and add thermal insulation.

Are External Slat Wall Panels easy to install?

External Slat Wall Panels are extremely easy to install. We have full installation instructions available showing 'how to' in a step by step guide. Designed and manufactured using an interlocking system, the panels are lightweight and durable and can be used in a number of situations.

Is it okay to install the External Slat Wall Panels as soon as they are delivered?

Temperature changes can cause composite board to expand or contract. We recommend that the boards are left for at least 48 hours to acclimatise to the surrounding temperature before install is started. It is not recommended to install the panels in extremely hot or cold temperatures.

Are any specialist tools needed to install the External Slat Wall Panels?

No specialist tools are needed to install the panels. The panels can be installed using the same tools as would be used to install timber panels.

Will the External Slat Wall Panels weather or fade?

The panels are designed and manufactured using the highest quality materials to withstand the elements and reduce fading and weathering. There may be a small percentage of fading in the weeks following installation, however this will be minimal due to the high quality resin used in the timber effect finish.

Are External Slat Wall Panels maintenance free?

Unfortunately not. As with all surfaces, regular cleaning will ensure the look and integrity of the panels will remain and reduce the risk damage. We have a simple care and maintenance guide available on our website outlining the basic requirements to keep your panels looking perfect and performing as expected.

Will External Slat Wall Panels rot and splinter the same as timber?

Being manufactured from a composite material, the panels will not rot or splinter.

INSPIRATION IMAGES

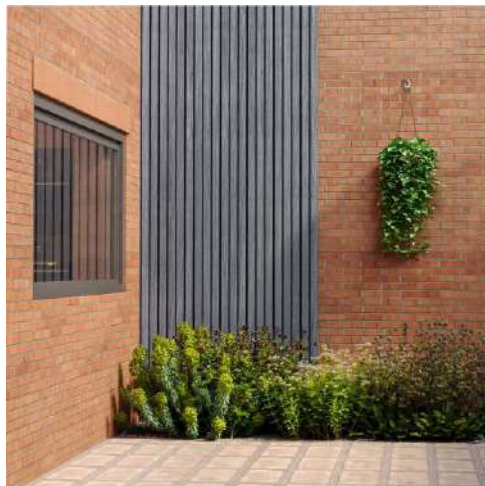

Golden Oak



Silver Grey Oak



THE WOOD WALL PANEL CO LTD

